

# *Glad Tidings*

## *April 2018*

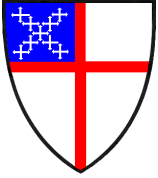

ST. ANTONY OF EGYPT EPISCOPAL CHURCH  
10239 Old Frontier Road  
Mailing Address: P.O. Box 2822, Silverdale, WA 98383 360-698-0555  
E-Mail: [stantonysilverdale@gmail.com](mailto:stantonysilverdale@gmail.com) Website: [www.saintantonys.org](http://www.saintantonys.org)  
The Rev. Bill Fulton, Vicar  
The Rev. Bill Thaete, Deacon



### *Vicar's Voice*

Many thoughtful people over the centuries have wondered why the original ending of Mark's Gospel portrays the women fleeing from the empty tomb in mute terror. You would think that, having just heard from an angel that Jesus was raised, they would be joyful at the good news.

But change - even good change for the better - can be difficult to face. The resurrection of Jesus was a wrenching change, and undoubtedly it took time for the women and the disciples to soak it in.

We are facing a big change in a few short weeks. We'll be leaving the building that has been our church home for many years and moving into a building that we don't know yet. What will it be like? Will it feel the same? Will it change us? Will we still feel surrounded by the presence of God and our church family, or will it be strange and uncomfortable?

The experience of coming to church is multi-sensory. When we come into our old familiar space, we're enveloped in sights, sounds and smells that assure us that we're in a safe place, and warm memories rush to meet us. It's not going to be easy to say goodbye.

But we remember that "the church is not a building." The church is the Body of Christ, a spiritual temple built of living stones. The church is the network of relationships that bind us together in Christ. No matter where we are, God is with us.

In Exodus we read how the Israelites wandered in the desert for forty years. And just as God travelled with the Israelites through the desert, God will travel with us the 1.4 miles down Old Frontier Road as we set up our tabernacle in a new place.

Of course there will be adjustments. It will take time for us to feel like the new building is our spiritual home. But I am sure that over time we will come to love our new home just as we have loved our old home. And we know that God will be with us.

Bill

*The mission of St. Antony's is to be a loving and welcoming people  
who worship God, grow in Christ, and serve others.  
Gather, Grow, and Go!*

## Parish Life

St Antony's volunteer Pastoral Care Team is a great way for our Christian community to care for one another. The Care Team provides calls, visits, meals and transportation assistance. If you are able to assist in any part of this ministry, please contact Beth Rohlfig. Contact the church office if you have a care need.

**Pastoral Care Team Meeting:** Saturday, April 7 at 11am in the church hall. Please join us if you would like to be a part of this team.

**Lay Eucharist Visitors:** Visitors are available to provide the Eucharist to parishioners who are unable to attend church. Please contact the church office to request a visit.

Beth Rohlfig, Parish Life Commissioner



**The Spring Kairos at Monroe** will be April 19-22 and we need your help.

Each Kairos weekend runs on prayer. We have a prayer support team that prays over each speaker before and again after their talk. This team also prays over every prayer request they receive (regardless of whether it comes from a team member or a participant) throughout the weekend. There is also a prayer vigil. These are people outside the prison who select a time to pray for the program, the participants, the institution, and the team. These prayers are offered from wherever they happen to be at the time they selected. Our goal is to cover the entire 4 days in prayer. I hope you will help with a piece of that. The prayer vigil sign-up sheet will be available in the Narthex until Sunday April 15.

Charles Smith

## Hospitality

Plans are continuing to be made for the June 21st Consecration Service at the new church at 6:30 pm. Printed invitations are being designed to send to our Peninsula Region Episcopal Churches. There will also be extra invitations available if you have someone special you want to invite, although space might be somewhat limited.

NEW....Our "Grand Open House and Arts and Crafts Fair" has been set for SATURDAY, AUGUST 4, 2018 from 10:00 am to 4:00 pm at the new church campus. This will be open to the public to attend, and advertised in the local papers. It will be a great time for all of us to use this Open House time to meet and greet the public as they circulate through the church and premise and see our beautiful building. You can all stop by at any time, OR, bring your own picnic lunch and blanket to set up out on the lawns, have cake and coffee in the Narthex, or buy a hot dog and soda at our food bar. This will be a festive Fair time with tables of arts and crafts by our own parishioners and friends, a bake sale in the Event Shelter, strolling musicians, a supervised play area for children, St. A's Time and Talent displays, and a fun day to slow down and enjoy the fruits of God's goodness.

Registration for a table area at the Fair will begin the last week in June. Some ideas for vendors are: paintings, cards, jewelry, knitting, wood working, quilts and fabric arts. No garage sale items. Bring your own table and set up items.

Call Tovi Andrews with your questions and registration. 360-779-2610

## *Transition Committee*

With the month of April St. Antony of Egypt nears the completion of construction of our new facility on the property near Trigger Gate. Next month we will be moving. Since all our current contents may not be needed, the Transition Committee asks that any group or organization (i.e. Altar Guild, Sunday School, Choir, etc.) to generate a list of items to take and items to discard or recycle. Each individual and organization needs to assist the process of moving. How many boxes will be needed, who will facilitate packing, does the group need to haul things away for disposal? As this month progresses, we need to be ready for each step needed for an efficient and effective move.

This is an exciting time for St. A's. Moving can be stressful, but with planning and preparation we will be ready and able to make it fun and joyful.

Thank you.  
Peter Stockwell  
Chair of the Transition Committee



## **KIDS, LETS HUNT FOR SOME EASTER EGGS**

**TIME** : 10:15

**WHERE**: New Fellowship church & saint Antony Church yard.

**BE PREPARED FOR**: Having an Easter egg basket and be ready for great smiles so... bring your camera.

**WHO**: New Fellowship Church & Saint Antony Kids.

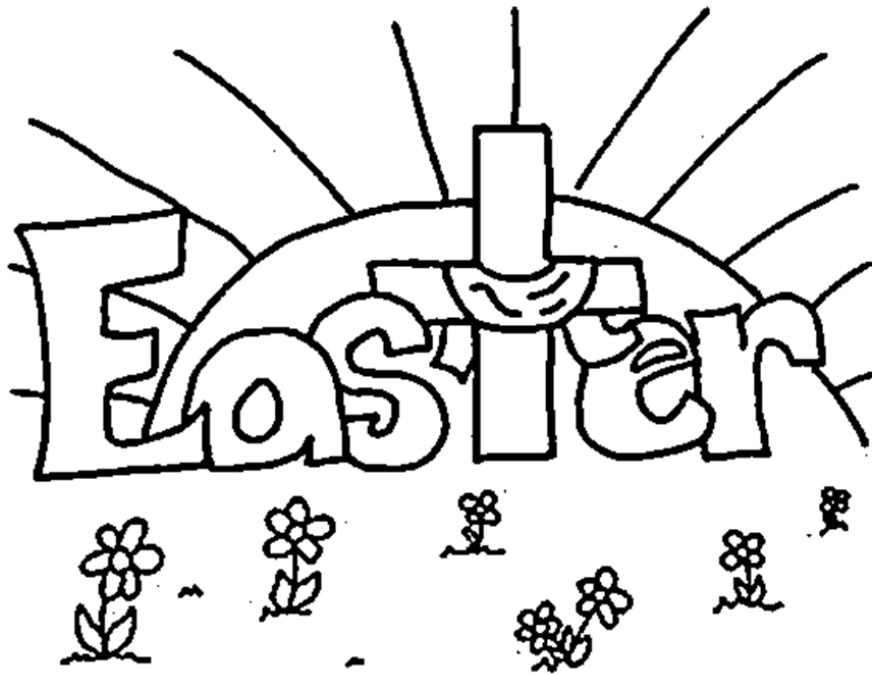

## *From the Altar/Flower Guild*

We are thankful and excited about the wonderful sign-ups for Easter flowers. You have been very generous. It helps us a great deal with the purchase of flowers as well as anything we need for the Altar.

We are very much looking forward to our move into our new church building. Once we are there we will need to buy new linens and other items for our big new Altar. Eventually, we will probably be replacing flower containers when needed, and so on. So here is an extra big thank you to all of you!

Caroline Hoag



## *A Bishop's Warden's Fancy*

In February at the annual retreat, the Bishop's Committee was presented with a case study of the process to discern a new Sunday School program, which resulted in the very successful Godly Play Program. Here I would like to give something of an overview of how St. Antony's came around to deciding on chairs for the new church. The Design Committee had been working in conjunction with the architect for years to design the interior spaces of the new church. While chairs are an obvious necessity, it was unclear what the plan was for them. Would we be able to afford new chairs? Would we want to repurpose the existing chairs? While we knew that permanent pews would not fit our needs, there were a lot of unanswered questions regarding the specifics of the chairs. We knew the exact location of every dimmer switch, electrical outlet, heating duct and drain spout, but the design of the chairs was put on an indefinite hold. With the year of our move in now upon us, it was time to make a decision if we wanted to be able to sit in our new space.

The Design Committee agreed that red was the obvious color choice; red would match our Gospel book, the hymnals, was a traditional liturgical color, and would add a pop of color to our crisp, clean (and predominately white) sanctuary interior. A few color swatches were presented to the Building Committee, and the bright red color seemed the best match. (Although understand the color was chosen from a one square inch swatch.) John Stockwell took it upon himself to reupholster a chair in the newly picked color and display it in the narthex. And this is when things got interesting...

This is where I think we did an excellent job as a church family. The plan for the chairs was presented to both congregations and Fr. Bill, myself and the entire Bishop's Committee welcomed feedback regarding the color. And boy did we receive feedback! More importantly, we listened and reacted to the feedback we received. We heard that the color was too bright, too orange, just not the right shade of red. So, we brought in some new, larger, swatches to choose from, and again presented them, encouraged and awaited feedback from the entire congregation.

I think this is so very interesting and important, because while the Design Committee was open to all members, it was a select few who participated in the design and contributed to the decisions made regarding the spaces of our church. We were very clear that all design decisions went through the design committee. So, in the end many of the choices for our new space were not discussed with the entire congregation. This process was very different, we heard from many members what their thoughts and feelings were about the chairs. I believe that we were very open and communicative about the fabric choice for the chairs. And in the end the decision to reupholster the chairs in the Claret color, the brighter, less purple, of the two new color options, won out. From the feedback that was collected this was the over all best pick. I think as a congregation with many different voices, we all came together to make the right choice.

With emotions running high surrounding the move in date of our new church, this is a great example of how well we can all work together, listen to one another and value each other's opinions, thus putting them to good use with a final outcome of beautiful new chairs in our beautiful new space. I am glad that in the end we all got to have our input into the design of the new church. I hope that in the future there will be more opportunities to listen and incorporate many voices into one.

Sarah Rogers  
Bishop's Warden

## *Outreach*

The Outreach committee met on March 5th to discuss the following:

1. The committee discussed, voted and approved to provide \$350.00 to Salvation Army to support the Bremerton detachment
2. I spent time with the CK food bank discussing their needs and program resulting in the following actions: the committee is working with Fr Bill to establish a date for a monthly Ingathering Sunday starting in May. This will give the congregation a means of regularly supporting the food bank. The committee will provide a list via the newsletter of what items the CK food needs. Please find it on the next page of this newsletter.
3. Please take the time to look at the outreach binder in the Narthex it contains a brief description of the Outreach Program and a Committee member list, a list of organizations in the Kitsap county area that you can support with your own time and talent, a section that shows what your committee has done to support the community, and a section that contain forms for you to bring your ideas for the congregation to support community outreach; just fill out the form and place it in the pocket in the note book or give it to a Outreach Committee member.
4. Please become involved we need your ideas and participation! The committee meets the first Monday of the month at 3:30 pm and at 7:00 pm at the Church; the late meeting is to support people who cant attend during the day.

### Bremerton Salvation Army overview

The Salvation Army has several programs providing services and support to those in our community who need basic assistance. We have a free meals program, food pantry, clothing bank, and a hygiene center, The hygiene center provides the homeless which provides daily showers and weekly laundry services. Social Services provide utility assistance during the winter, Thanksgiving Food Boxes and Christmas Gifts and Food Boxes for families. The Salvation Army also runs a Winter Homeless Shelter from December to the end of March. The church has a weekly women's group, bible study, and Sunday services

"I am only one, but I am one. I cannot do everything, but I can do something.  
And I will not let what I cannot do interfere with what I can do." -Edward Everett Hale

Blaine Morgan  
Phone or Text 360-674-8192  
blaine.morgan67@yahoo.com

Here is the latest list of needs from the Central Kitsap Food Bank.

Our first food ingathering will be in May. Please see bulletin for more details as they come.

Blaine Morgan



[www.ckfoodbank.org](http://www.ckfoodbank.org)

### **Essential Needs**

**Most Needed at this Time: Sugar, Peanut Butter, Tuna, Chili, Cheese, Laundry & Dish Soap**

- Canned Veggies
- Canned Fruit
- Soup
- Tomato products (sauce, stewed, diced)
- Noodles/pasta (all types)
- Macaroni & Cheese
- Boxed Dinners
- Instant Potatoes
- Cereal
- Pancake Mix
- Crackers
- Gravy/Seasoning Mix
- Cooking oil
- Jelly
- Condiments (all types)
- Tea
- Juice
- Powdered Drinks
- Hygiene Items: Shampoo, Conditioner, Toothpaste, Toothbrushes, Deodorant, Facial & Toilet Tissue
- Diapers (all sizes except newborn)



## *Communications & People's Warden*

The buzz is all about the new church building; less than 3 months until completion! The picture below was taken 19 March 2018; it's nice to see the roof trusses and the shape of the building coming together. The interior church drawing is also provided to help orientate. Please visit the St. Antony's website: <http://saintantonys.com/> for a wonderful photo timeline of construction progress.

Heather Carnocki



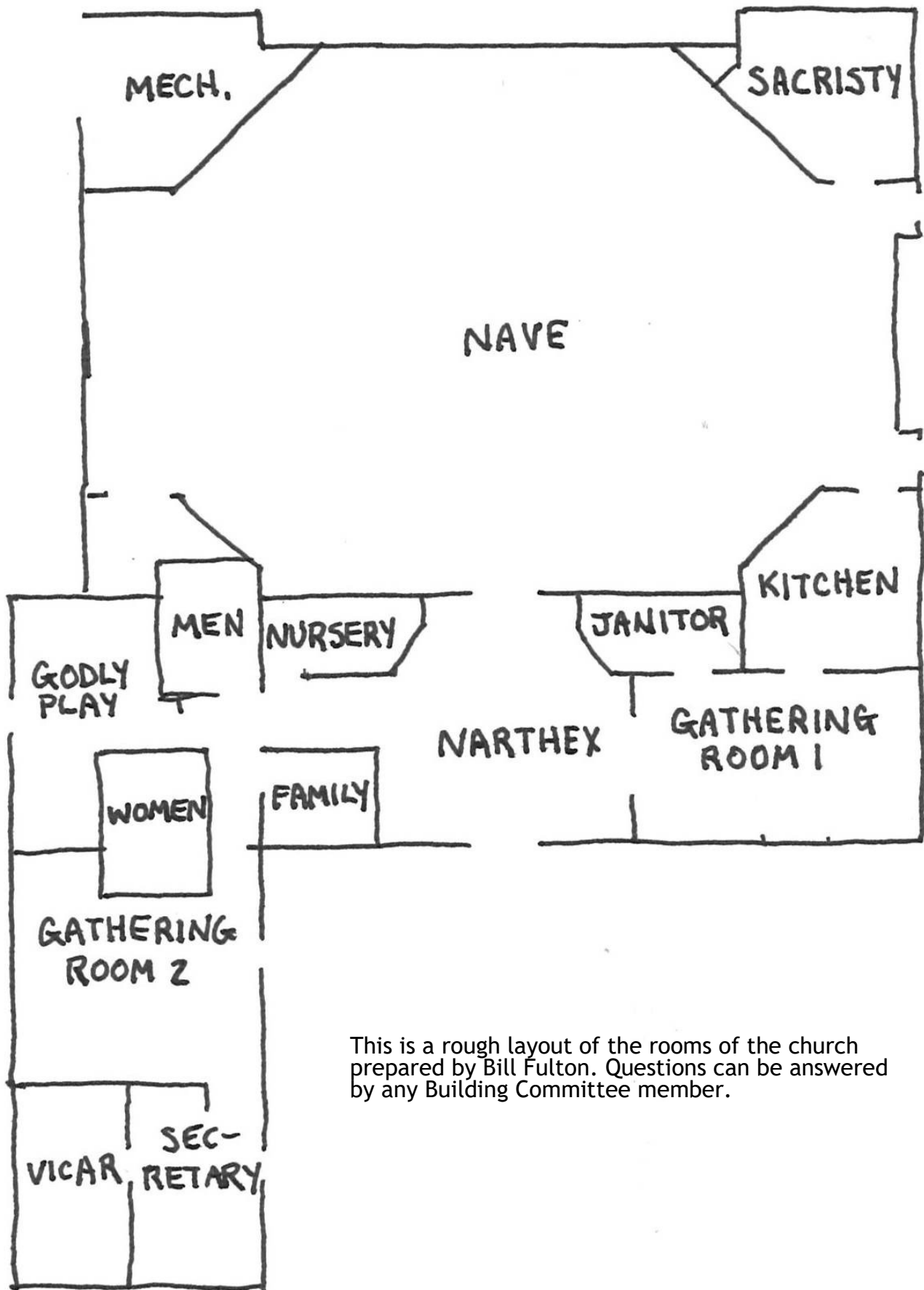

This is a rough layout of the rooms of the church prepared by Bill Fulton. Questions can be answered by any Building Committee member.





## April Birthdays

1	David Ferguson
4	Pete Morris
12	Jan Peterson
16	Carolyn Segrist
	Olivia Stalter
17	Aaron Feenstra-Wilson
20	Joann Richardson
25	Sandy Stockwell
26	William George
30	Marin Mash



## April Anniversaries

2	Jim & Eva Smith

Deadline for the May Glad Tidings is **Tuesday, April 24th** at 10 am.  
Please send all submissions to:  
stantonysilverdale@gmail.com. Thank you.



Matthew & Karen Grubb  
Damien and Devon  
3505 Cedar Grove Street  
Bremerton, WA 98310  
540-290-2146  
grubb.bills@gmail.com

Correction:

(This info is in your new directories but please cross out Karen as one of their children. They have two wonderful boys only)

### Directory Corrections:

Jean Mackimmie Cell phone: 360-509-4527

Thomas Alessio email: alessiotawm@gmail.com

(Please make notes in your directory)

Financial Report February **Preliminary**		Account Balances	
Operating Income	\$18,523.67	Local Checking	\$436,143.35
Operating Expenses	\$17,225.55	Local Savings	\$58,824.45
<b>Net in February</b>	<b>\$1,298.12</b>	Diocesan Investment Funds	\$939,003.75
		<b>Total</b>	<b>\$1,433,971.55</b>

April 2018 Schedule					
JOBS	April 1 Easter Sunday	April 8 Second Sunday of Easter	April 15 Third Sunday of Easter	April 22 Fourth Sunday of Easter	April 29 Fifth Sunday of Easter
EM 7:30 am	Ruth Lindstrum	Ruth Lindstrum	Elizabeth Moorhead	Elizabeth Moorhead	Donna Hilton
LC/OT & NT 7:30 am	Elizabeth Moorhead	Donna Hilton	Norma Tipton	John Teller	Ruth Lindstrum
GREETER 7:30 am	Jim Smith	Darrow L.	John & Jane Teller	Rod & Marin Mash	Jacque Walker
					<b>Youth Sunday</b>
EM 9 am	Shane Carlson	Peter Stockwell	Bill Thaete	Peter Stockwell	Charles Smith
LC/OT 9 am	Jim Foley	Gail C.-Ferguson	David Wilkinson	Jim Foley	Christina W.
LC/NT 9 am	Michael Wentworth	Stu Smith	Larry Little	Cris McCarty	Kate Z.
ACOLYTES 9 am	Kate Z. Aina Z. Christina E.	Declan J. Charles S. Cris M.	Jason W. Christina W. Benjamin W.	Mackenzie W. Lauren P. Chelsea R.	Christina W. Kate Z. Aina Z.
GREETER 9 am	Suzanne Brock	Nancy Ladenberger	Tovi Andrews	Liz Haney	Damien G. & Carlson Family
USHER 9 am	Mark Westin	Chris Crowson	David Sorrell	David & Jan Peterson	Laurel & Luke R.
COUNTERS	Heidi F-W Chris Crowson	Jim Foley Jacque Walker	Bill Cleveland Nancy Ladenberger	David Wilkinson Bill Cleveland	Heidi F-W Norma Tipton
COFFEE HOUR	David W & Declan J	Sylvia Campbell	Amy Wentworth	Beth Rohlfing	Karen & Matt Grubb
Eucharistic Visitors	Kathy	P: Beth. / B: Declan	P: Emori / B: Kathy	P. Loretta/B: Penney	P: Beth / B: Olivia
1st LESSON	Acts 10:34-43	Acts 4:32-35	Acts 3:12-29	Acts 4:5-12	Acts 8:26-40
PSALM	Psalms 118:1-2, 14-24	Psalms 133	Psalms 4	Psalms 23	Psalms 22:24-30
2nd LESSON	1 Corinthians 15:1-11	1 John 1:1-2:2	1 John 3:1-7	1 John 3:16-24	1 John 4:7-21
GOSPEL	Mark 16:1-8	John 20:19-31	Luke 24:36b-48	John 10:11-18	John 15:1-8

Roster of Volunteers for Services If you cannot serve on your assigned Sunday, please call someone from this list. (A strike through a name means they are not available now but will be back.)					
LECTORS	EUCCHARISTIC MINISTERS	GREETERS	COUNTERS	USHERS	ACOLYTES
<b>7:30 AM</b>	<b>7:30 AM</b>	<b>7:30 AM</b>	Bill Cleveland A	Chris Crowson	Carleton M.
Donna Hilton	Donna Hilton	Donna Hilton	Chris Crowson B	<del>Ray Flagg</del>	Christina E.
Ruth Lindstrum	Ruth Lindstrum	Darrow Lindstrum	Jim Foley A	<del>Pete Morris</del>	Declan Jarry
<del>Elizabeth Moorhead</del>	Elizabeth Moorhead	Rod & Marin Mash	Nancy Ladenberger B	Dave & Jan Peterson	Cris McCarty
John Teller	<del>Bill Reeder</del>	Jim Smith	Norma Tipton B	<del>Ed Segrist</del>	Lauren P.
Norma Tipton	Charles Smith	John & Jane Teller	Jacque Walker B	Dave & Carolyn S.	Chelsea R.
Mardi Dawson (sub)	John Teller	Jacque Walker	David Wilkinson A	Mark Westin	Mackenzie W.
	Bill Thaete		Heidi Feenstra-WilsonA		Benjamin W.
<b>9 AM</b>	<b>9 AM</b>	<b>9 AM</b>	A - computer		Christina W.
Shane Carlson	Shane Carlson	Tovi Andrews	B - non computer		Jason W.
Gail C- Ferguson	Declan Jarry	<del>Ray &amp; Elizabeth Flagg</del>			Aina Z.
<del>Elizabeth Flagg</del>	<del>Kathy Little</del>	Liz Haney			Kate Z.
Jim Foley	Chelsea Reeder	Nancy Ladenberger			
Declan Jarry	<del>Carolyn Segrist</del>	Carole Nau			
Larry Little	Charles Smith	Malcolm & Sylvia (substitute)			
Cris McCarty	Peter Stockwell				
<del>Carolyn &amp; Ed Segrist</del>	Bill Thaete				
Stu Smith	<del>Mary Zabinski</del>				
David Wilkinson					
Michael Wentworth					

# April 2018

<i>Sun</i>	<i>Mon</i>	<i>Tue</i>	<i>Wed</i>	<i>Thu</i>	<i>Fri</i>	<i>Sat</i>
<b>1 Easter Sunday</b> <b>7:30 am</b> <b>Holy Eucharist</b> <b>9 am</b> <b>Holy Eucharist</b> Nursery Baptism of Devon Grubb <b>10:15 am</b> Egg Hunt	<b>2</b> <b>3:30 pm</b> Outreach Mtg. <b>7 pm</b> Outreach Mtg.	<b>3</b> <b>7 am</b> Sonshine Fellowship <b>1 pm</b> Memorial Fund Mtg.  6pm Scouts	<b>4</b> <b>9 am</b> <b>Morning Prayer</b>	<b>5</b> <b>Noon</b> Vicar's Bible Study <b>7:00 pm</b> Building Committee Mtg.	<b>6</b> <b>Vicar's Day Off</b>	<b>7</b> <b>11 am</b> Pastoral Care Mtg. <b>1-6 pm</b> Writing Group
<b>8</b> <b>7:30 am</b> <b>Holy Eucharist</b> <b>9 am</b> <b>Holy Eucharist</b> Godly Play & Nursery Renewal of Wedding Vows Malcolm & Sylvia <b>5 pm</b> Contemplative Prayer Service	<b>9</b>	<b>10</b> <b>7 am</b> Sonshine Fellowship	<b>11</b> <b>9 am</b> <b>Morning Prayer</b> <b>5:30 pm</b> <b>Holy Eucharist</b> <b>6:15 pm</b> Potluck <b>7:00 pm</b> Program	<b>12</b> <b>Noon</b> Vicar's Bible Study <b>6:30 pm</b> Bishop's Committee Meeting	<b>13</b> <b>Vicar's Day Off</b>   <b>Vicar's Day Off</b>	<b>14</b> <b>1-6 pm</b> Writing Group
<b>15</b> <b>7:30 am</b> <b>Holy Eucharist</b> <b>9 am</b> <b>Holy Eucharist</b> Godly Play & Nursery <b>4 pm</b> Rite 13	<b>16</b> <b>11 am</b> Witty Knitters	<b>17</b> <b>7 am</b> Sonshine Fellowship <b>1 pm</b> Worship Planning Meeting	<b>18</b> <b>9 am</b> <b>Morning Prayer</b> <b>5:30 pm</b> <b>Holy Eucharist</b> <b>6:15 pm</b> Potluck <b>7:00 pm</b> Program	<b>19</b> <b>Noon</b> Vicar's Bible Study	<b>20</b> <b>Vicar's Day Off</b>	<b>21</b> <b>1-6 pm</b> Writing Group
<b>22</b> <b>7:30 am</b> <b>Holy Eucharist</b> <b>9 am</b> <b>Holy Eucharist</b> Godly Play & Nursery <b>5 pm</b> Contemplative Prayer Service	<b>23</b>	<b>24</b> <b>7 am</b> Sonshine Fellowship <b>10 am</b> Newsletter Deadline  6pm Scouts	<b>25</b> <b>9 am</b> <b>Morning Prayer</b> <b>5:30 pm</b> <b>Holy Eucharist</b> <b>6:15 pm</b> Potluck <b>7:00 pm</b> Program	<b>26</b> <b>Noon</b> Vicar's Bible Study	<b>27</b> <b>Vicar's Day Off</b>	<b>28</b> <b>1-6 pm</b> Writing Group
<b>29 Youth Sunday</b>  <b>7:30 am</b> <b>Holy Eucharist</b> <b>9 am</b> <b>Holy Eucharist</b> Godly Play & Nursery	<b>30</b>					

***St. Antony's Episcopal Church  
10239 Old Frontier Road,  
P O BOX 2822  
Silverdale, Washington 98383***

***[www.saintantonys.org](http://www.saintantonys.org)***

***The mission of St. Antony's is to be a loving and  
welcoming people who worship God,  
grow in Christ, and serve others.***

***Gather, Grow, and Go!***