

St. Antony of Egypt Episcopal Church Reopening Plan



Revision 3.2 – 24 June 2020

Welcome

Welcome to the Reopening Plan for St. Antony of Egypt Episcopal Church, Silverdale, WA. We hope that these guidelines will, when the bishop of the Diocese of Olympia approves reopening, allow us to reopen our Sunday services with no health impact on our attendees.

When the time comes we will be opening the 10:15 Eucharist for people to attend in person.

There are several sections addressed in this plan:

- Welcome
- General guidelines
- Building entry procedure
- The service
- Exiting the building
- Descriptions and definitions
- Nave Layout
- Incident Reporting
- Post Exposure Recovery

Each of these sections will be specifically addressed.

General Guidelines

- If you have any cold symptoms such as a cough, please stay home as a sore throat, runny nose, sneezing
- If you have a temperature exceeding your normal temperature by 1.5 degrees or more please stay home. You will be asked to not enter the church building if your temperature exceeds 100 degrees.
- Wear a non-surgical mask at all times, if one does not have a mask one will be provided
- If anyone refuses to wear a mask, they will not be permitted to enter the building and will be provided information on live-streaming remote viewing
- Wash your hands for 20 seconds before leaving your home
- Use the provided hand sanitizers when entering the building or the nave
- Social distancing, please stay 6ft apart as a family unit
- Use only the seats provided, please do not move chairs
- Restrooms are restricted to one person in the room at a time, please wash your hands before and after using the facility
- No child care will be provided
- Do not congregate in groups inside of the building
- Avoid physical contact
- Clergy will wear non-surgical masks throughout the service
- Clergy will wash their hands and use hand sanitizer frequently
- We will follow the Episcopal Diocese of Olympia "A Guide to Gathering in Person" guidelines
- All altar party members will be educated on our COVID-19 policies

Building Entry Procedure

- Wear a non-surgical face mask when you exit your car
- Maintain social distancing, 6ft apart by family unit or individuals
- You will be met at the door of the church by a greeter who will check your temperature with a non-contact thermometer and ask you general health questions
- The door for entry is the “gathering room” door near the kitchen
- If your temperature is elevated or you do not feel healthy you will be asked to return home
- There will be no physical contact
- The greeter will direct you to the registration station, where you will register (Required by the diocese)
- Registration stations are in the narthex
- Please use hand sanitizer before entering the nave
- An usher will then direct you to pick up a Service Bulletin from the table
- You may place your offering in the plate at the back of the naïve
- The usher will then direct you to your assigned seat. The church will be filled from the front to the back

The service

- Wear a non-surgical mask throughout the service
- There will be no hymnals or BCPs in the nave
- The complete service will be printed in the service bulletin
- Lay readers will come forward to the lectern, remove their masks and read, their mask will be replaced before they return to their seat
- There will be no physical contact during the peace
- To receive communion come forward in the following sequence:
 - The last row on the right (facing the altar) will come forward down the center aisle as directed by the usher, maintaining social distance
 - Each person will sanitize their hands at the sanitizer station
 - They will receive the Host, on their hand, and take several steps to the right, remove their mask, consume the Host, replace their mask and return to their seat up the right side
 - The last row on the left (facing the altar) will come forward down the center aisle as directed by the usher, maintaining social distance
 - Each person will sanitize their hands at the sanitizer station
 - They will receive the Host, on their hand, and take several steps to the left, remove their mask, consume the Host, replace their mask and return to their seat up the left side
 - Each row moving forward from the last row starting with the right side and then the left side will follow the same pattern to receive communion
- Only the presider receives the chalice
- All clergy will wear a non-surgical mask throughout the service except for speaking
- All clergy will wash the hands for at least 20 seconds prior to the service
- All clergy will use hand sanitizer often during the service
- There will be no procession or recession by the clergy, to help maintain social distancing
- There will be no acolytes or crucifers in the services
- Singing by the congregation will be held to a minimum

Exiting the building

When the service has ended, after the dismissal, everyone will exit the building maintaining social distancing. After the service exiting families can share with other families, social time, in the parking lot or under the event shelter while maintaining social distancing.

Descriptions and definitions

Greeter – person who checks the temperature and basic health conditions of people as they enter the church building. The greeter will wear a mask and gloves, avoiding physical contact.

Usher – person who assists with seating and movement in the sanctuary. The usher will wear a mask and gloves, avoiding physical contact. During the service the usher will observe the service and assist attendees with maintaining the required safety requirements.

Registration station – location where attendees and attendees' families record their attendance and temperature. If the attendee's name is recorded in the parish phone book no other information is required. If the attendee's name is not in the parish phone directory the following information is required: name, address, phone number, email address and temperature. (Required by diocese)

Note: Greeters and ushers will be trained prior to performing the duties and educated on our COVID-19 policy.

Nave Layout

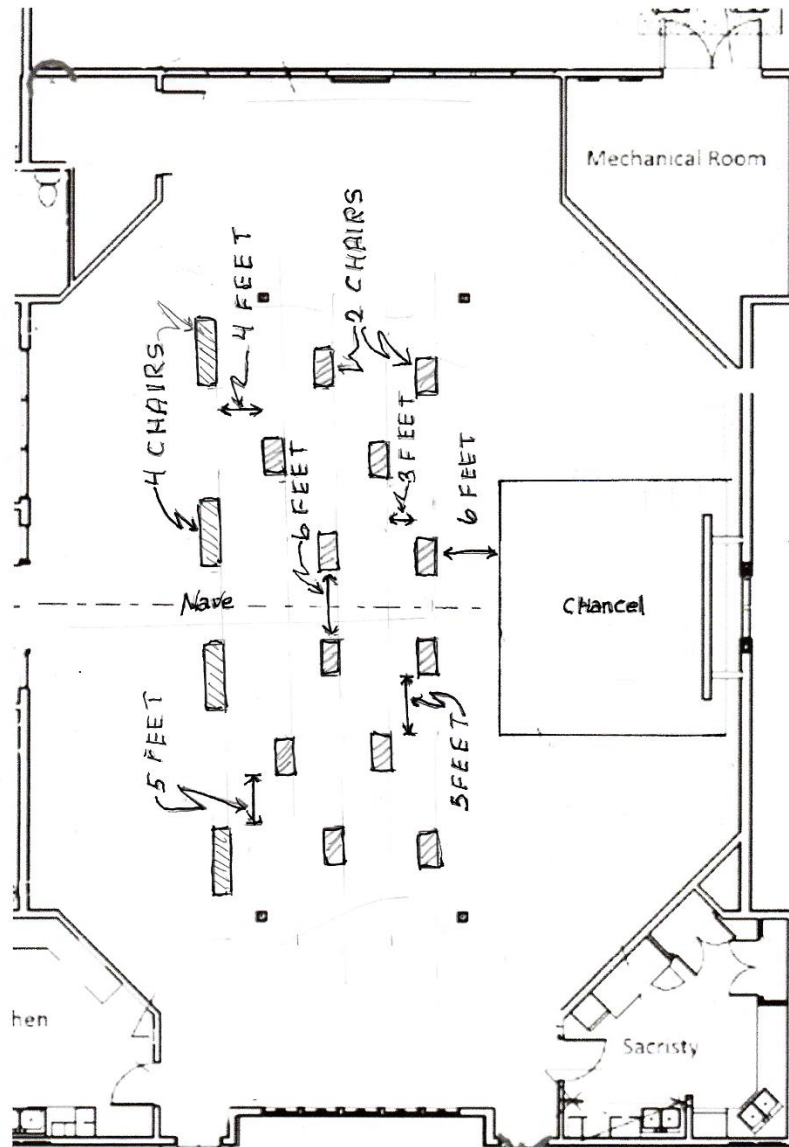

Chairs will be in groups of twos and fours; for singles, couples and families.

Additional seating may be provided in the side areas as the state reopening phases change.

Incident Reporting

If any attending any service reports contracting Covid-19 the following step must be taken in response.

- All services will be stopped until Post Exposure Recovery steps have been completed.
- All members and non-attending members will be notified via the phone tree.
- State health department will be given names and contact information for all church attendees for the prior 21 days.
- The Office of the Bishop will be notified.

Post Exposure Recovery

- All door handles, chair backs and touchable surfaces will be completely cleaned and sanitized.
- All restrooms will be completely cleaned and sanitized
- The sacristy will be completely cleaned and sanitized
- The ventilation system will be increased for 24 hours